

## High Power Optical Isolator (TGG type 850nm~1064nm)

### Features

- Low Insertion Loss
- High Return Loss
- High Isolation
- High Stability and Reliability

### Application

- Fiber Amplifier
- Test System
- MOPA Fiber Laser
- Fiber Laser

### Specifications

| Parameter                        | Value                     |
|----------------------------------|---------------------------|
| Center Wavelength (nm)           | 1064, 1030, 980, 850, 780 |
| Bandwidth (nm)                   | ±5                        |
| Typical Peak Isolation @23°C(dB) | 30                        |
| Isolation@23°C(dB)               | 25                        |
| Typical Insertion Loss @23°C(dB) | 0.8                       |
| Insertion Loss @23°C(dB)         | 1.0                       |
| PDL@23°C(dB)                     | 0.15                      |
| Return Loss (dB)                 | 45                        |
| Power Handling (CW) (W)          | 0.5/1.0/5.0/10/20         |
| Dimensions (mm)                  | 60x28x26                  |
| Max. Peak Power(kW)              | 1                         |
| Tensile Load(N)                  | 5                         |
| Operating Temperature (°C)       | +10~+50                   |
| Storage Temperature (°C)         | 0~+60                     |

\*For device with connector IL is 0.3dB higher RL is 5dB lower ER is 2dB lower.

\*The default connector key is aligned to slow axis.

### Package Dimensions

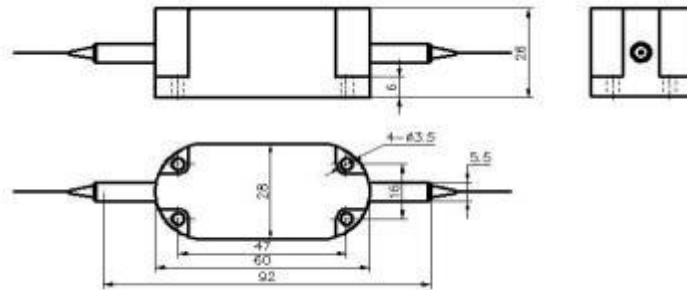

### Ordering Information

| HPIIS | Wavelength  | Type           | Working axis | Fiber Type           | Pigtail Type       | Length | Connector |
|-------|-------------|----------------|--------------|----------------------|--------------------|--------|-----------|
|       | 0780=780    | S=Single stage | N=non-PM     | 3=HI780fiber         | 1=250um bare fiber | H=0.5m | 0=None    |
|       | 0850=850nm  |                |              | 1=HI1060fiber        | 2=900um loose tube | 8=0.8m | 1=FC/UPC  |
|       | 0980=980nm  |                |              | S=Customer specified | 3=3 mm loose tube  | 1=1.0m | 2=FC/APC  |
|       | 1030=1030nm |                |              |                      |                    | 5=1.5m | 3=LC/UPC  |
|       | 1064=1064nm |                |              |                      |                    | 2=2.0m | 4=LC/APC  |
|       |             |                |              |                      |                    | 3=3.0m | 5=SC/APC  |
|       |             |                |              |                      |                    | 4=4.0m | 6=SC/UPC  |